

Flat 6, Woodland Court Hart Hill Drive, Luton, LU2 0AX
£925 Per month

- EXCLUSIIVE TO PR PROPERTY
- 2-minute walk to Luton station
- Ideal for singles or couples

- One-bedroom apartment
- On-site parking
- Available late May 2026

- Woodland Court, Hart Hill Drive, Luton
- Close to local transport links

** Exclusive to PR Property ** A smart one-bedroom apartment in Woodland Court on Hart Hill Drive, Luton, offered to rent Late May 2026. Set in the town center, this flat sits about a two-minute walk from Luton station and benefits from on-site parking and close local transport links, making it a practical option for singles, couples and commuters. The accommodation provides a compact, low-maintenance base in a well-connected location

ENTRANCE HALL

LIVING ROOM 15'00 X 13'1 (4.57M X 3.99M)

KITCHEN 11'1 X 5'10 (3.38M X 1.78M)

BEDROOM 11'8 X 8'10 (3.56M X 2.69M)

BATHROOM

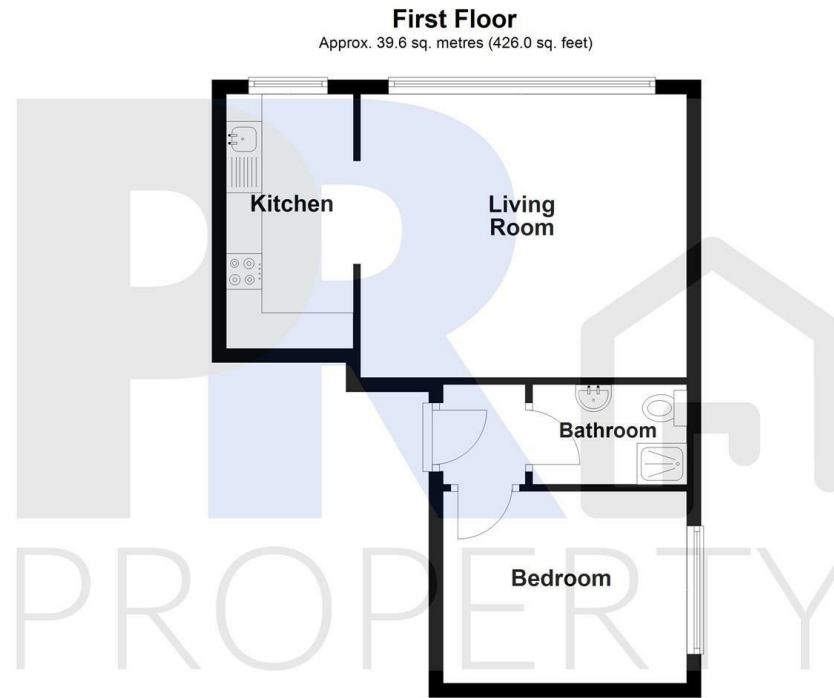

Total area: approx. 39.6 sq. metres (426.0 sq. feet)
6 Woodland Court, Luton

Energy Efficiency Rating		Current	Potential
Very energy efficient - lower running costs			
(92 plus)	A		
(81-91)	B		
(69-80)	C		78
(55-68)	D		
(39-54)	E	50	
(21-38)	F		
(1-20)	G		
Not energy efficient - higher running costs			
England & Wales		EU Directive 2002/91/EC	